

HDP49-05 to suit Invert  
Flare Brake Lines

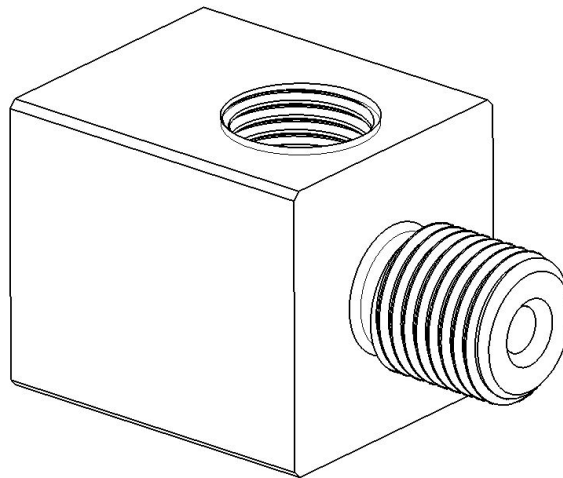

HDP49-06 to suit ISO  
Flare Brake Lines

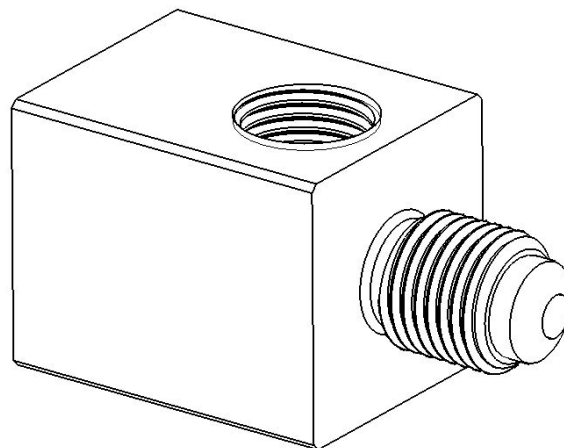

## Installation Guide

1. These adapters are designed to use AiM Brake Pressure sensor part no: X05PSA00160B10
2. Use the provided 10mm copper washer between the brake pressure sensor and the sensor mount
3. For additional leak insurance we recommend applying Loctite 577 thread sealant to the male threads of
  - a. The adapter fitting
  - b. The sensor
  - c. The brake line tube nut