

| No. | Description      | Quantity |
|-----|------------------|----------|
| 1   | CDV Delete Plate | 1        |

# Installation Guide

## 1. Locate your Clutch Master Cylinder

- a. Typically, this will be located on the firewall, behind your engine. To access this area you may need to disassemble an upper panel section at the base of the windscreen (refer to factory service manual for how to do this).



## 2. Remove the Clutch Master Cylinder From the Car

- a. Disconnect the clutch pedal clevis, do this by removing the drivers seat and getting up into the pedal area, then remove a retaining clip and push the pivot pin out of the clutch pedal clevis. Be sure to keep the pin and clip somewhere safe for reassembly later.
- b. Disconnect the clutch line from the clutch master by pulling the retaining clip (13) out and wiggling the line fitting free.

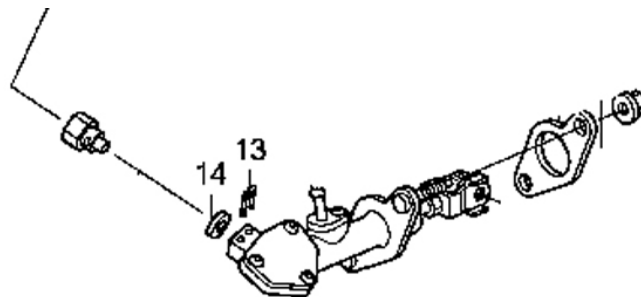

- c. Disconnect the line from the clutch fluid reservoir, taking care to manage any fluid leaks.
- d. Back in the drivers foot well, undo the nuts holding the clutch master cylinder to the firewall. It should now be free to be removed from the engine bay.

**3. Remove the Three Torx Fasteners Holding the Original CDV Top Plate in Place**

- a. You will need a torx T30 driver with hollow centre as shown below.

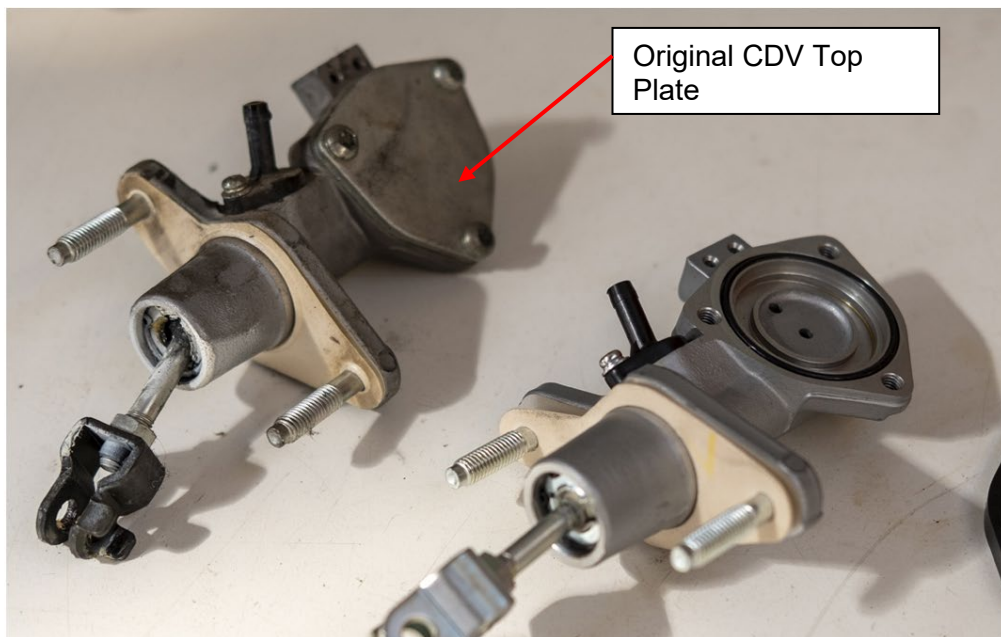

**4. Remove the Round Wire Ring**

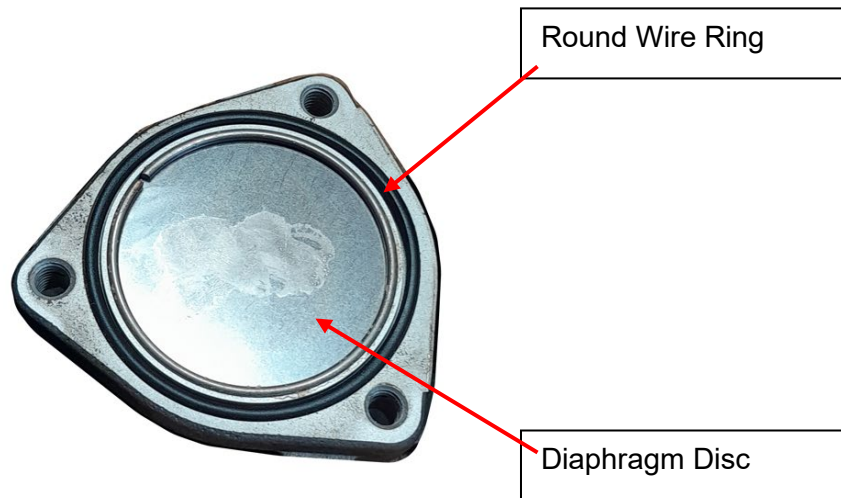

**5. Remove the Diaphragm Disc**

- a. If necessary, push it out from the back with a small screwdriver.

**6. Remove the Inner Seal**

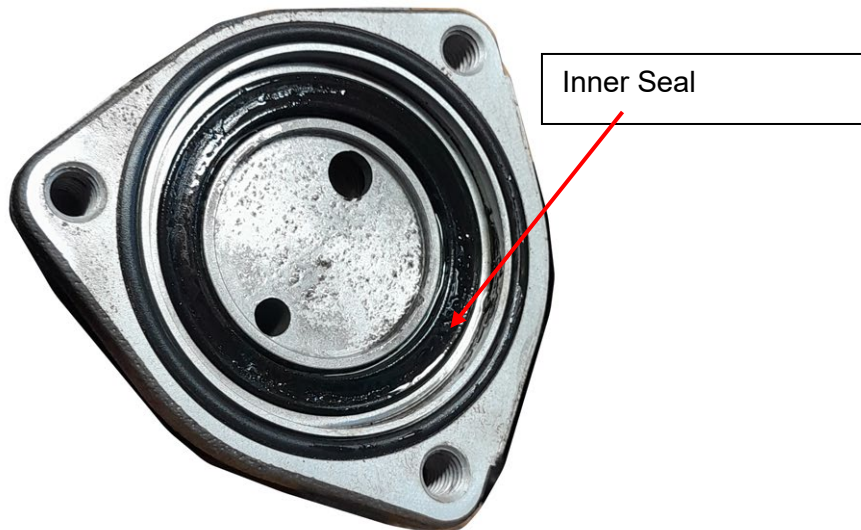

**7. Clean the Inside of the CDV**

- a. Use brake Cleaner and dry with a rag.

## 8. Fit the Honed CDV Plate to the OE Housing

- a. Take care to ensure the detail on the back side is aligned with the ports in the housing.
- b. To confirm, the intention is to re-use the original outer o-ring. Inspect and ensure this is clean before fitting the new plate.

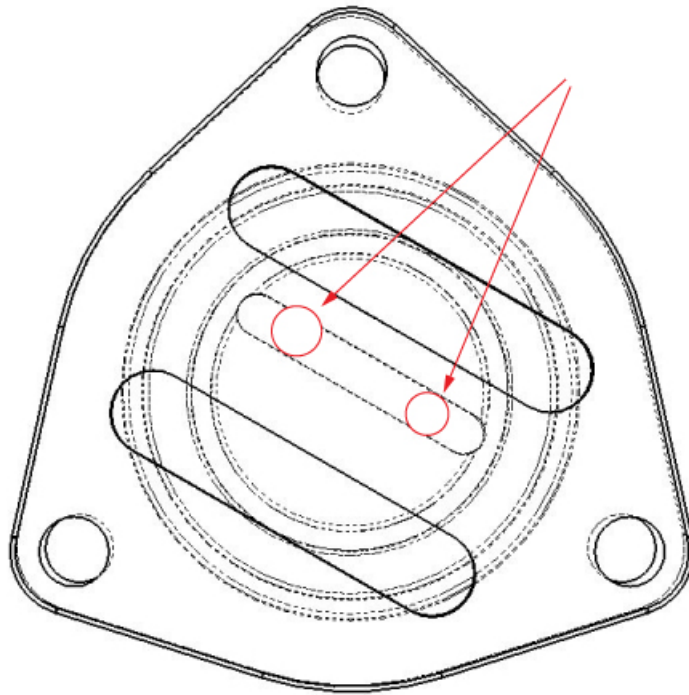

Note the hole orientation does differ in the case of some clutch master cylinders.

- c. Fasten the CDV Plate to the Clutch Master Cylinder with the original hardware.

## 9. Reinstall the Clutch Master Cylinder

## 10. Bleed the Clutch and Check for Leaks

- a. Once you are confident there are no leaks proceed to take the vehicle for a test drive.

### Tips to follow if you have issues bleeding the clutch line

- Make sure the reservoir cap on the clutch fluid reservoir is off/open
- Unbolt the reservoir and raise it above the master cylinder
- Bleed fluid through each section of the clutch line from the master cylinder down to the slave, checking for fluid at each connection.
- Pump the slave cylinder by hand
- Make sure you have someone pumping the clutch pedal