

No.	Description	Quantity
1	CDV Delete Plate	1
2	M6x16 Flange Bolts	3
3	Crush Washer	2

Installation Guide

1. Remove CDV from vehicle

- a. You want to disconnect the clutch hardline and soft line from the CDV and leave these in the vehicle. Be prepared to catch leaking brake fluid an/or drain the clutch reservoir before beginning.



2. Remove the three torx fasteners holding the original CDV top plate in place.

- a. You will need a torx T30 driver with hollow centre



3. Remove the round ring

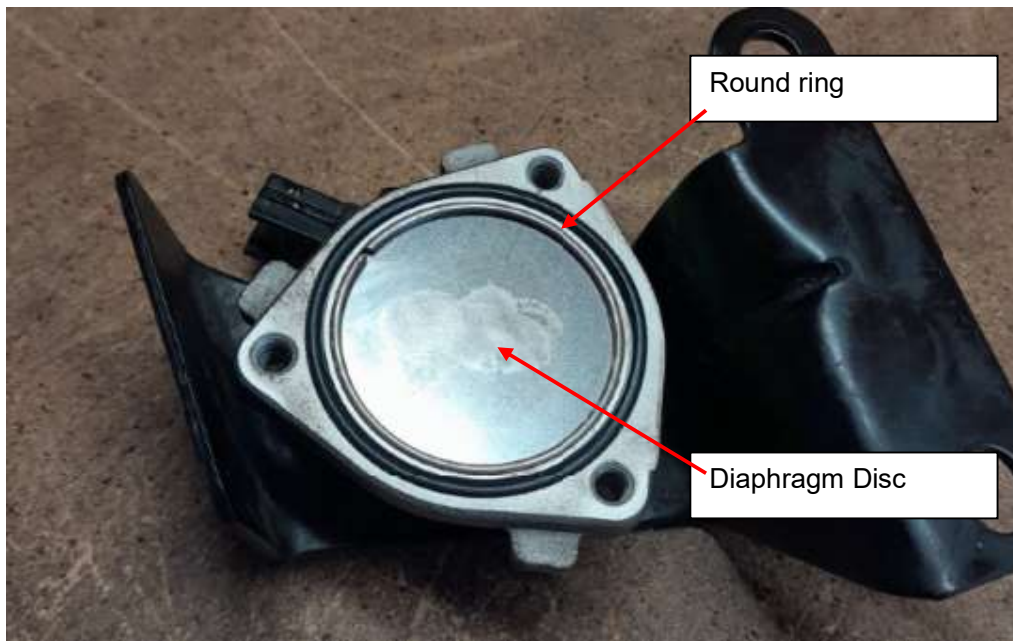

4. Remove the original disc – if necessary push it out from the back with a small screw driver



5. Remove the inner seal

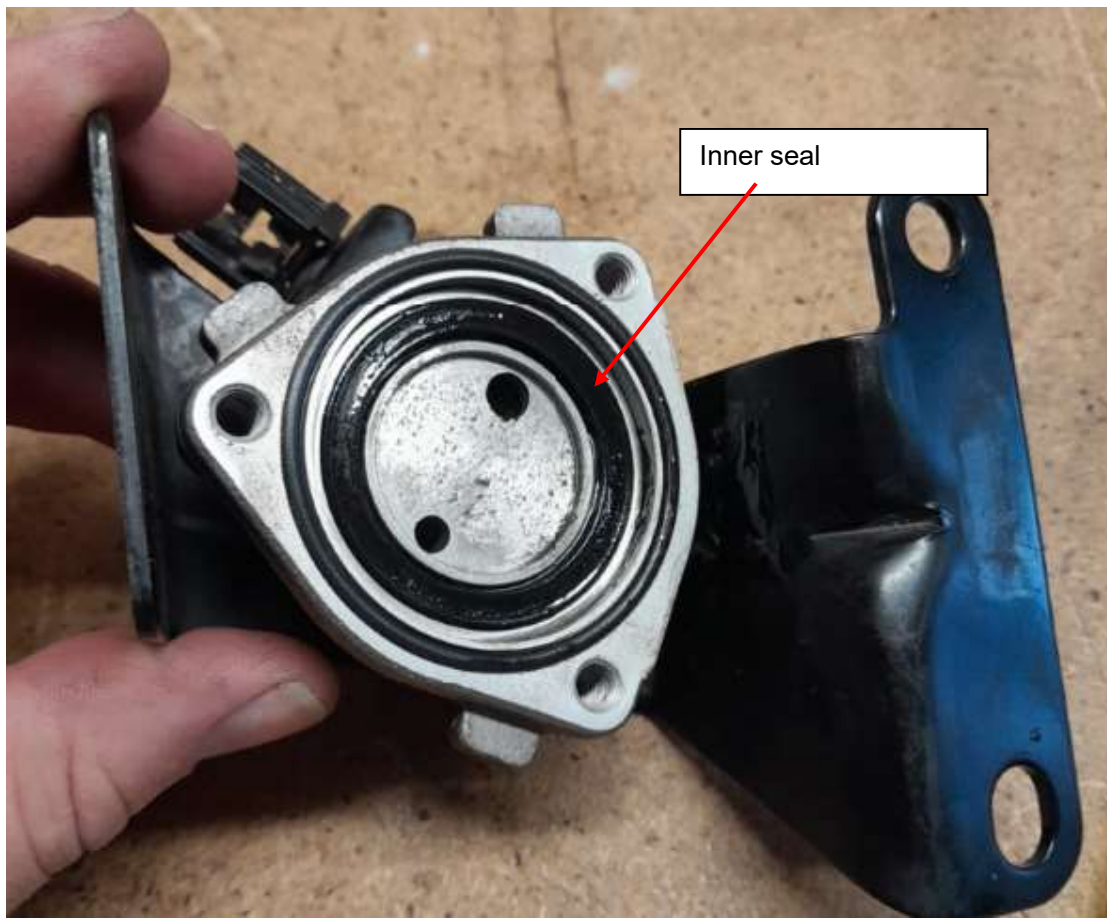

6. If necessary clean the inside of the CDV with brake cleaner and dry with a rag
7. Fit Honed CDV plate to the OE housing – take care to ensure the slot on the back side is aligned with the ports in the housing
 - a. To confirm, the intention is to re-use the original outer o-ring. Inspect and ensure this is clean before fitting the new plate.

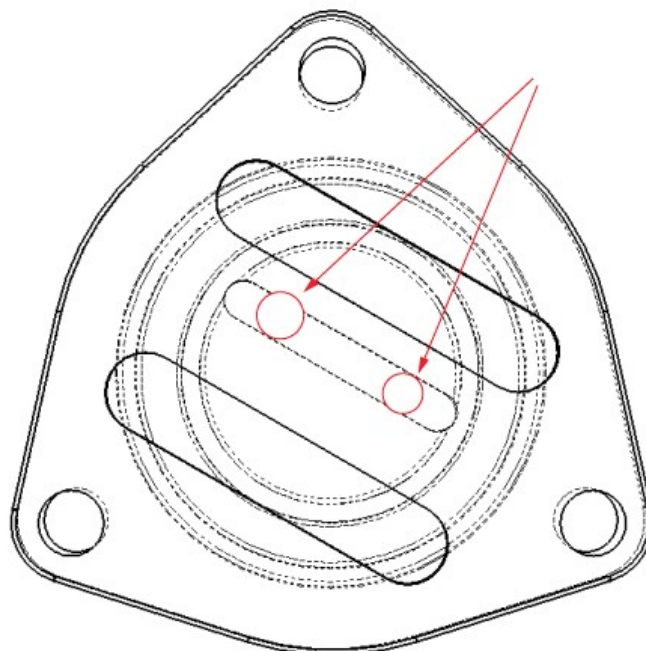

10. Bleed the clutch and check for leaks

11. Once confident there are no leaks proceed to take the vehicle for a test drive