

225l/h In-Tank Fuel Pump

Data Sheet



- ▶ >225 litres-per-hour @ 4bar (58 psi)
- ▶ 38mm diameter body, suitable for upgrading many standard in-tank pumps
- ▶ Draws ~12.5A @ 5.5bar (80 psi)
- ▶ Male outlet fitting to suit 8mm ID, 11mm OD inlet port
- ▶ Note: no pressure relief valve (system must have independent valve and/or return)

The Bosch Motorsport 225l/h In-Tank Fuel Pump is a turbine style pump for installation inside the fuel tank. It is capable of providing over 225l/h at 400kpa (4bar/58psi). Please see attached flow tables for volume at other benchmarked fuel pressures. Benefit from Bosch's OEM expertise when you fit this Motorsport-validated fuel pump to your race or modified vehicle.

Application		Technical Specifications	
Delivery rate at 5 bar and 25°C	226.7l/h at 14V	Mechanical Data	
Pressure limiting valve	N/A	Diameter	38mm
Fuel compatibility	Up to E85 with shorter lifetime	Length	113.7mm
Diesel compatibility	Not released	Mounting	Clamping
Operating temperature range	-30 to 70°C		
Operating Voltage	13.5V		

Performance Tests Passed

High Temperature Performance	Dry Run Test	Sour Gas Operation	Low lubricity & corrosive fluid tests
Low Temperature Performance	Thermal Cycling	Dust Added Gasoline	Reverse Polarity
10,000hr durability test	Immersion Test	Over Voltage (Jumpstart)	

Flow Data

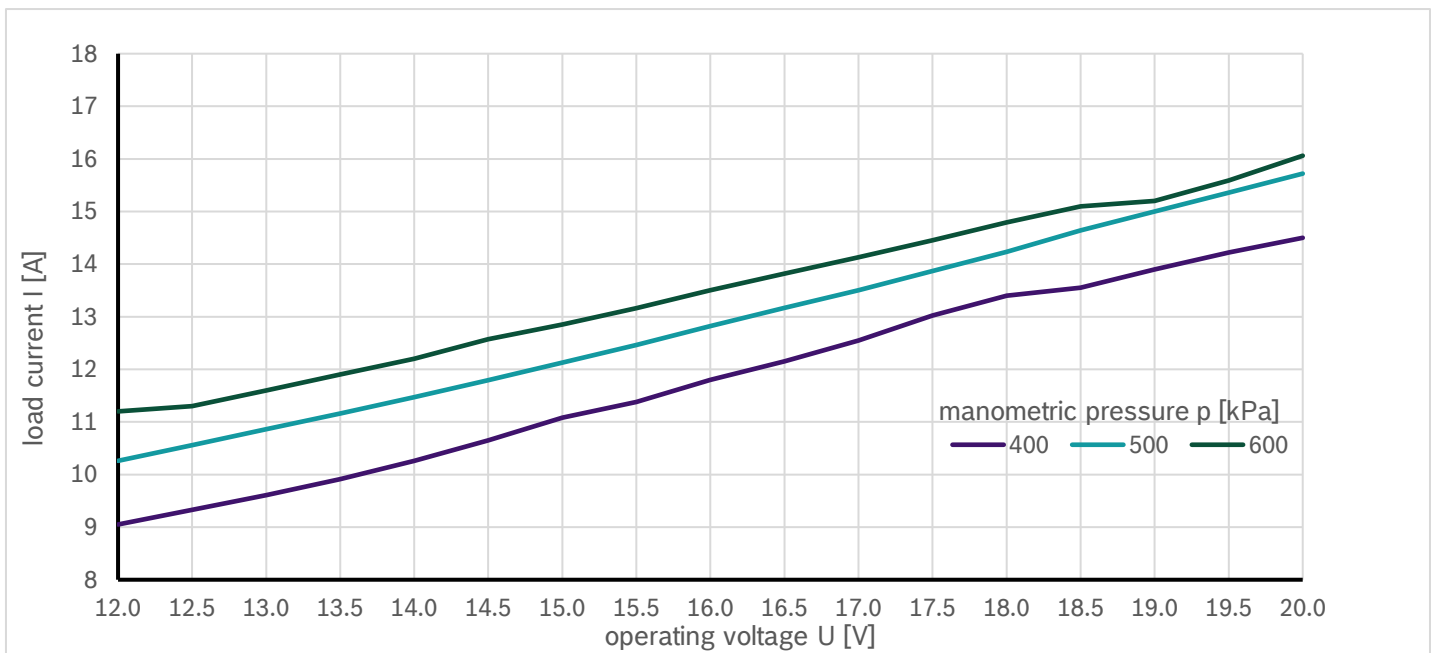
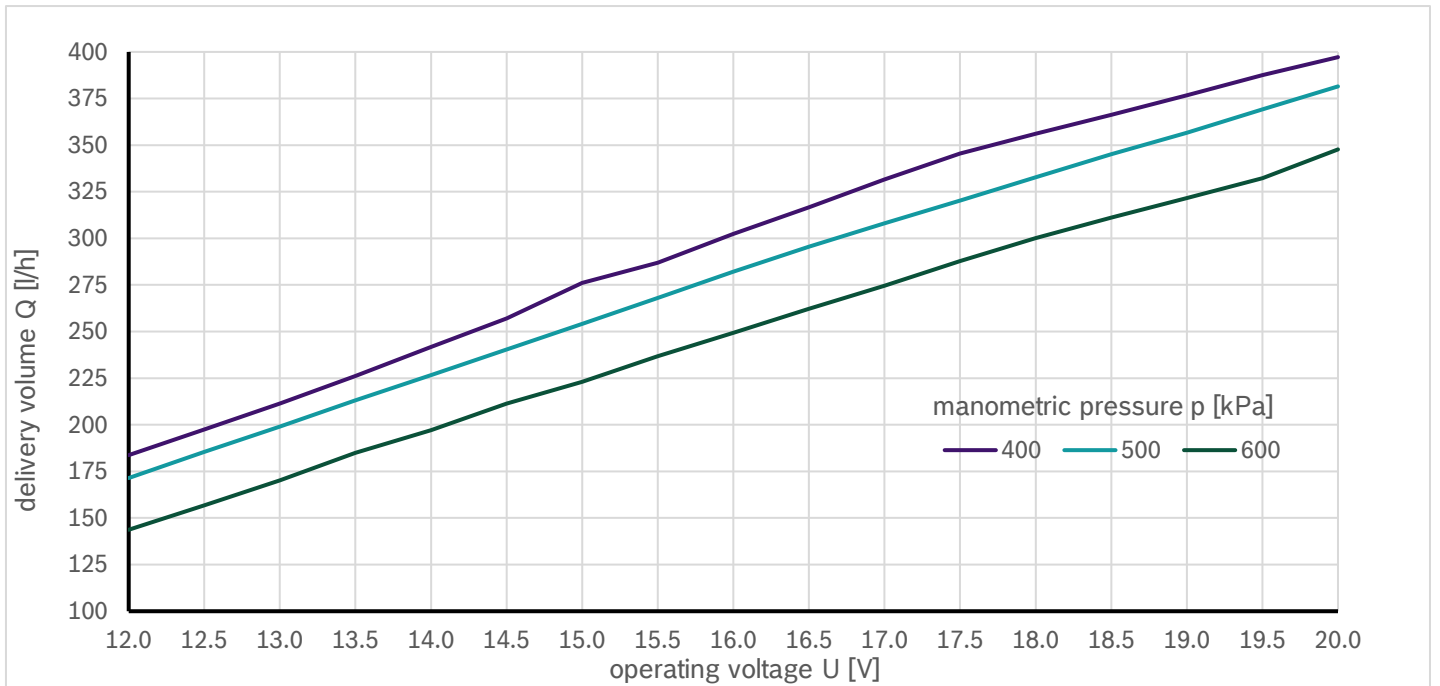

Dimensions

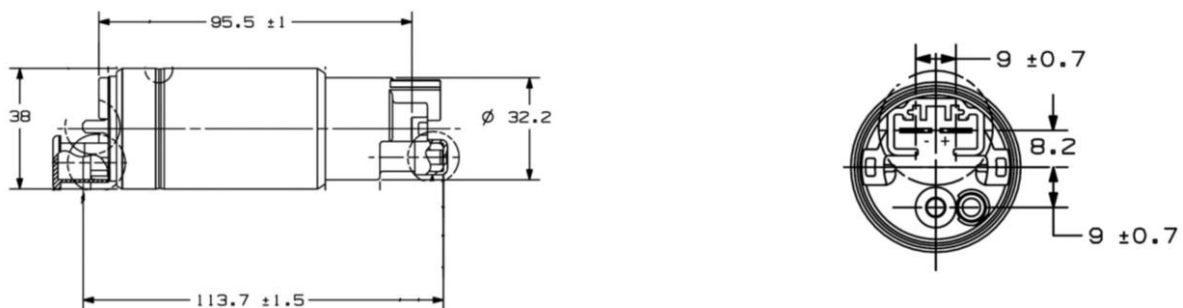

Bosch Motorsport Australia

RBAU/MSD
1555 Centre Rd
Clayton
VIC 3168
Australia

Motor.Sport@au.bosch.com