

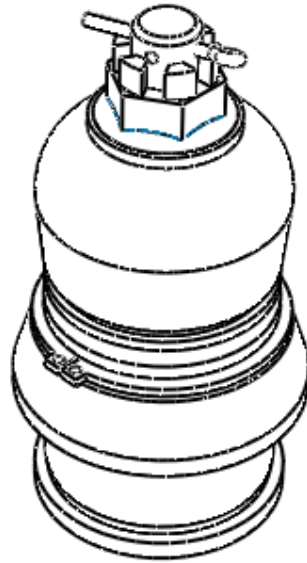

# Front Roll Centre Correction Ball Joints Civic, CR-X and Integra - HDP16-01

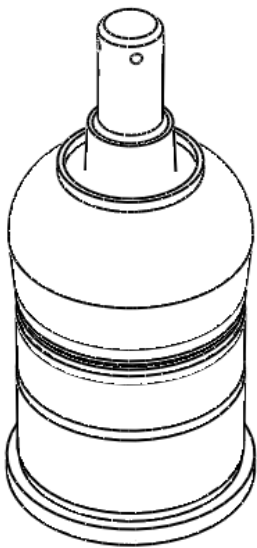

No.	Description	Quantity
1	Roll centre correcting ball joint	2
2	Support sleeve	2
3	Castle nut	2
4	Circlip	2
5	Split pin	2



1

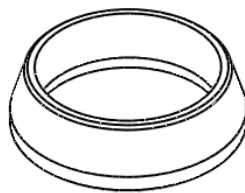

2

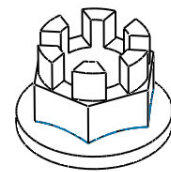

3

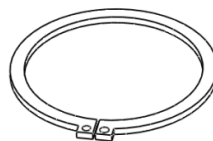

4



5

1. Remove the front suspension knuckles from the vehicle. Follow the procedure in the service manual for your vehicle.
2. Remove the dust shield ring from the rear face of the knuckle.
3. Remove the original lower ball joint from the knuckle. The easiest method is to clamp the knuckle in a bench vice, remove the rubber boot from the lower ball joint, and then using a suitable tube placed over the ball joint stud to bear up against the main body of the ball joint, hammer the ball joint using the tube until the ball joint is free.
4. With the ball joints removed, check the ball joint bores for damaged and ensure they are clean and dry.
5. Place the Honed roll centre correcting ball joint in the bore in the knuckle. Situate the knuckle in a hydraulic press and press the ball joint in using two suitable pieces of tubing. A tube of 41mm (1 5/8") inner diameter to support the underside of the knuckle, and a tube of approx. 35mm (1 3/8") inner diameter against the ball joint base.
6. Remove the ball joint boot and retaining clip. Install the support sleeve. The sleeve is a tight fit and must be driven into place using a hammer and a suitable sized tube of approx 41mm (1 5/8") inner diameter until it is flush against the lower surface of the knuckle. Install the circlip in the groove in the ball joint using circlip pliers.
7. Reinstall the ball joint boot and retaining clip.
8. Reinstall the rear dust shield ring in the knuckle.
9. Repeat steps 2 through 8 for the other knuckle.
10. Reinstall the knuckles in the vehicle using the castle nut and split pin provided. Follow the procedure and torque specifications for the service manual for your vehicle.
11. After installation the vehicle will require a wheel alignment. If fitted the Honed bump steer correcting tie rod end kit the bump steer setting must be checked and re-set. Refer to the instructions for the bump steer kit for further details or contact us at [sales@honeddevelopments.com](mailto:sales@honeddevelopments.com).

**Note: These components are intended for race use only, and will require regular inspection and maintenance. Honed will not be held responsible for any misuse of these components.**

### Example Images

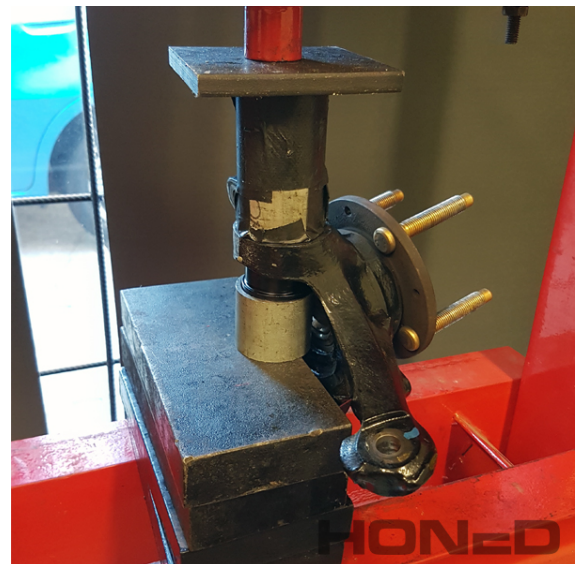

## **Ammendment: Alternative Support Ring**

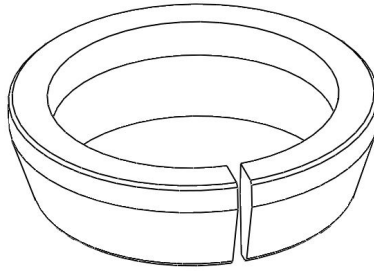

**If you received a gold support ring like the one shown above, please read the following:**

Installation steps 1-5 remain the same.

Install the ball joint retaining circlip **before** attempting to fit the support ring

Fit the Support Ring, use a suitably sized piece of pipe (or press tool) and lightly tap the sleeve until the base of the sleeve is touching the circlip.

Refer to step 7 and continue following the steps on page 2.

**Note:**

It's necessary to remove this style of support ring in order to access the ball joint retaining circlip. To do this, use a flat blade screw driver or similar in the support ring slot to wedge and expand the support ring.