

No.	Description	Quantity
1	Splitter Mount Chassis Side Assy (LH and RH)	2
2	Blade Brackets (LH and RH)	2
3	Coach Bolts	6
4	1/4" Nyloc Nuts	6
5	M8 X 30 Flanged Hex Head Bolts	4

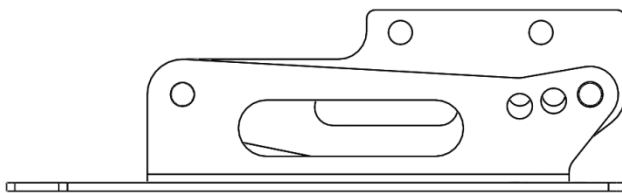

1

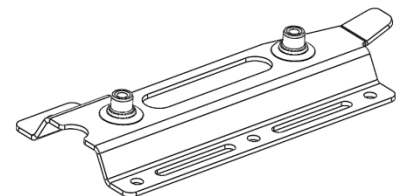

2

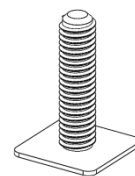

3



4

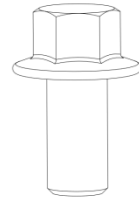

5

1. Jack up car and support on jack stands
2. Mount the chassis side bracket to your specific chassis either by welding along the top edge or bolting through the hole provided

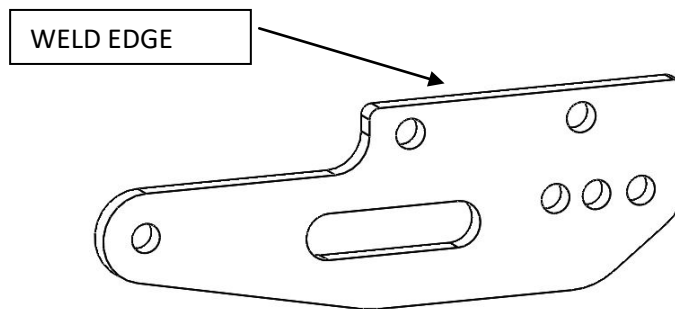

3. Find the distance between brackets once both sides are installed on the car

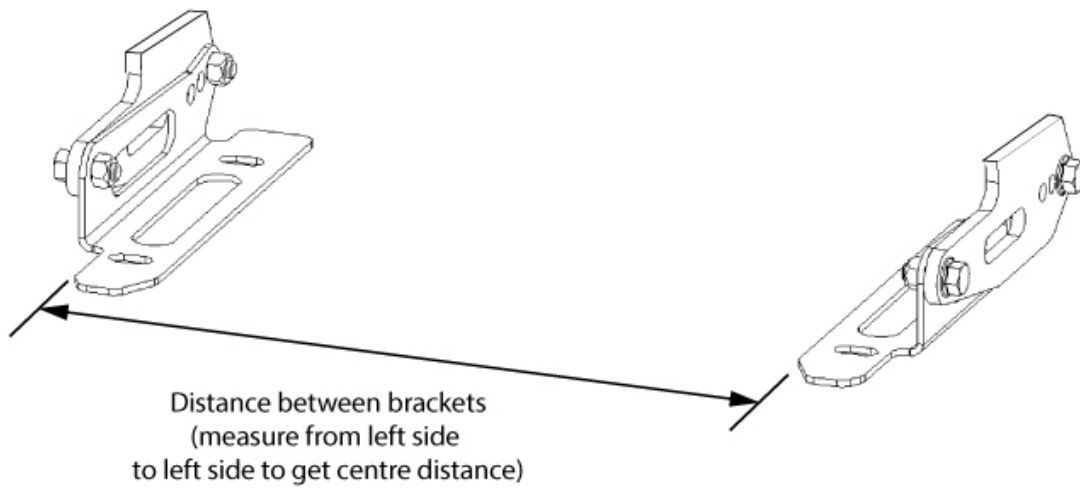

4. Mark out centreline on splitter blade

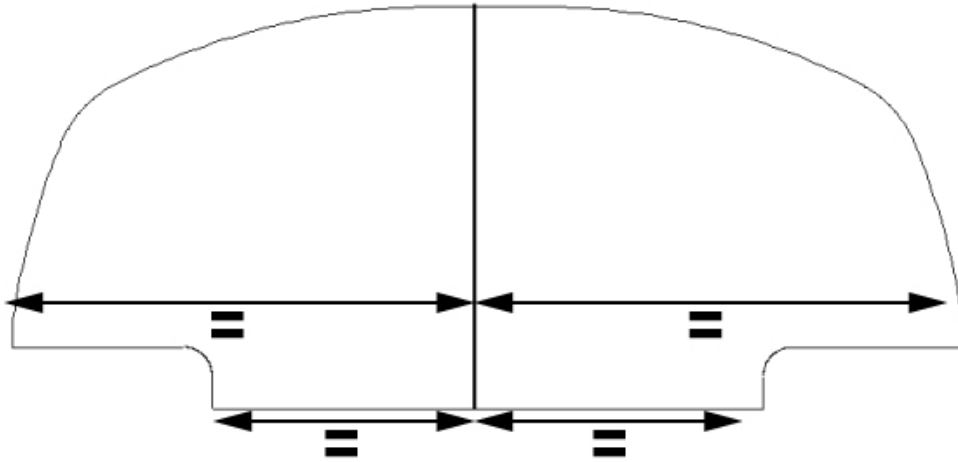

5. Mark out bracket position lines,  $X = \text{Distance between brackets}/2$

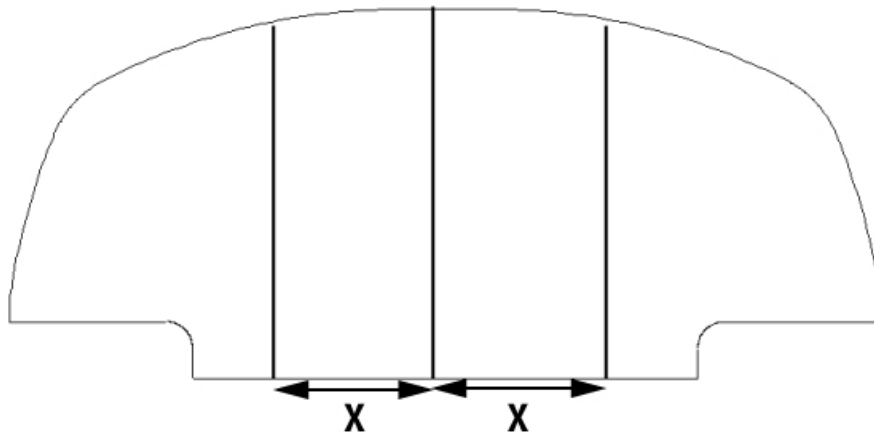

6. Offer splitter blade up to car, press it against bottom of splitter mounts attached to car. This step is easier with a second set of hands to support splitter blade.
7. Centre splitter blade best as possible on vehicle centreline.
8. Position the blade with ~50mm (2") protruding forward from leading edge of your bumper/lip.
9. Measure along one of the bracket position lines from the edge of the splitter back to the front edge of the bracket attached to the car.
10. With splitter blade back on bench, mark this position on each of the bracket position lines and then scribe a horizontal line across the splitter

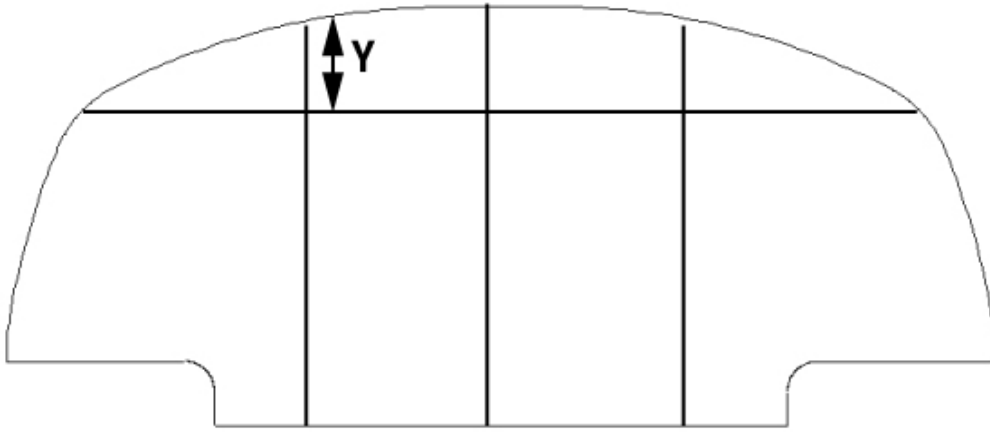

11. Cut "Honed Splitter Bracket Template" in half down the indicated centre line

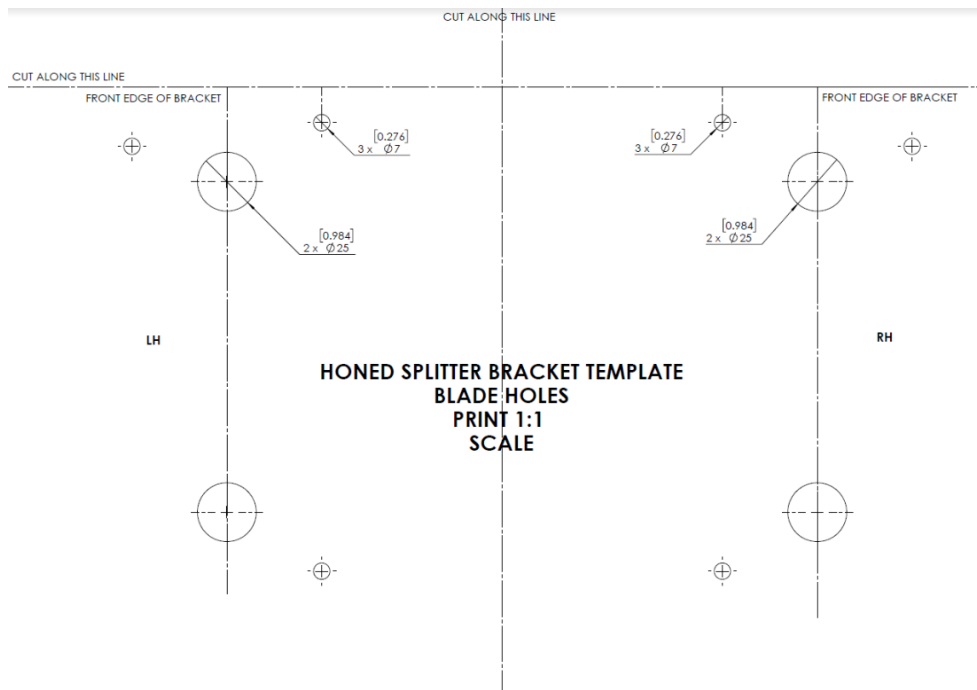

12. Line up the drilling templates with the lines on the splitter blade as shown below. Tape templates down.

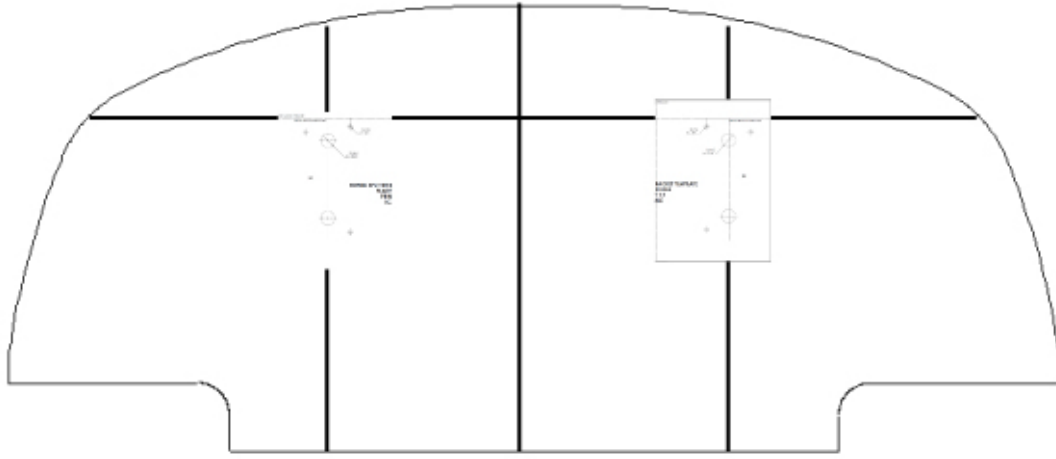

13. Centre punch or pilot drill through the template into your blade and then follow through with bits to create the specified holes sizes

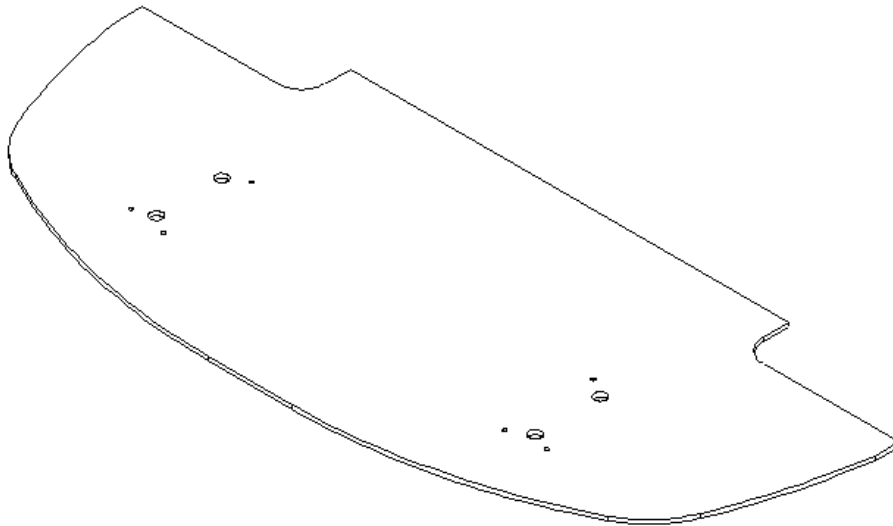

14. Bolt the splitter blade side brackets to the splitter and test fit

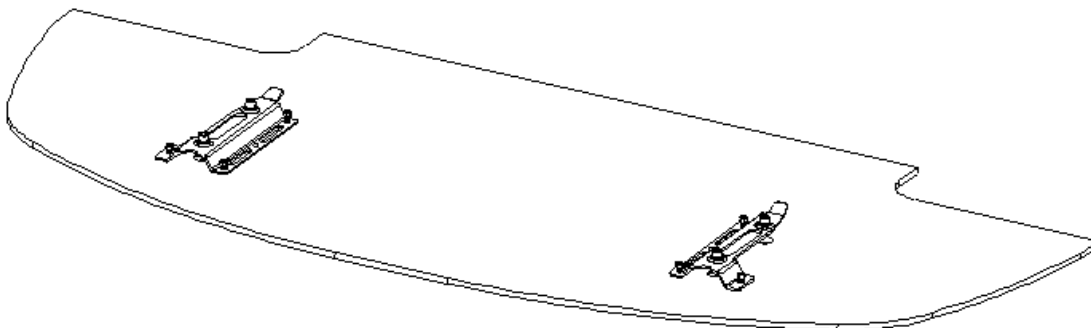

15. Use a marker pen to trace the profile of your bumper/lip down onto the splitter blade

16. We use a wheel arch flare screwed to the splitter to fill the gap between the splitter and the bumper/lip

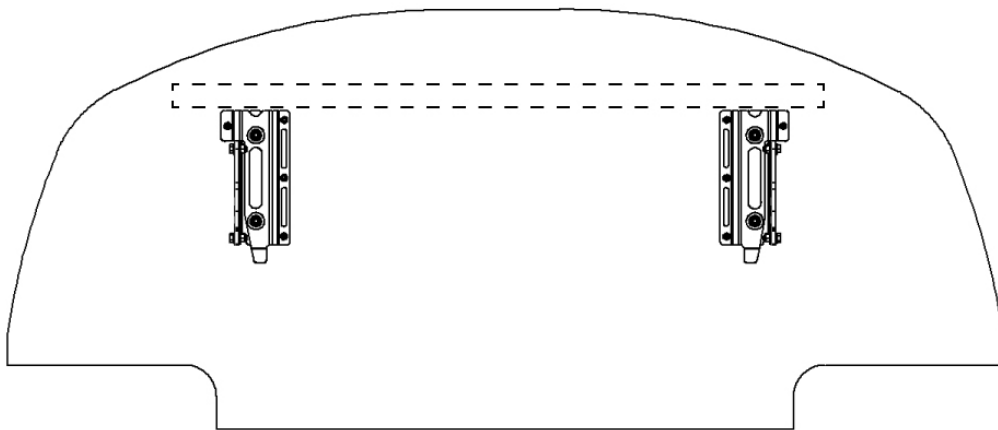

Figure 1: Normal orientation of wheel arch flare (as sold)

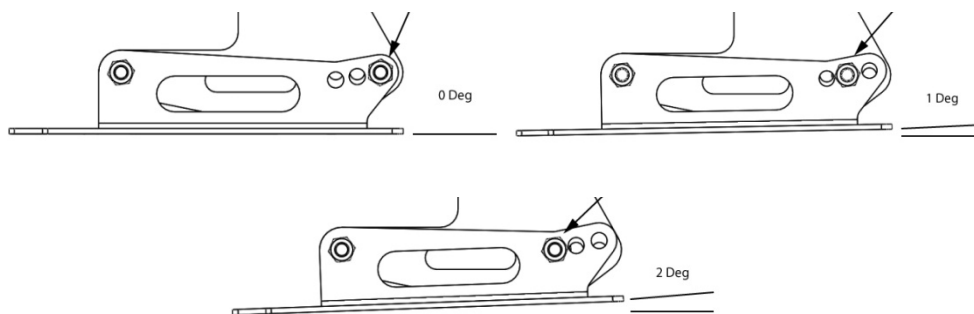

Figure 2: As used on splitter

17. We recommend adding additional bracing in the area shown below



18. Angle of attack adjustment



**Note: These components are intended for race use only, and will require regular inspection and maintenance. Honed will not be held responsible for any misuse of the components.**