

No.	Description	Quantity
1	Splitter Mount Chassis Side Assy (LH and RH)	2
2	Blade Brackets (LH and RH)	2
3	Coach Bolts	6
4	1/4" Nyloc Nuts	6
5	M8 X 30 Flanged Hex Head Bolts	4

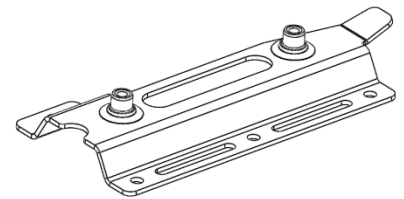

2

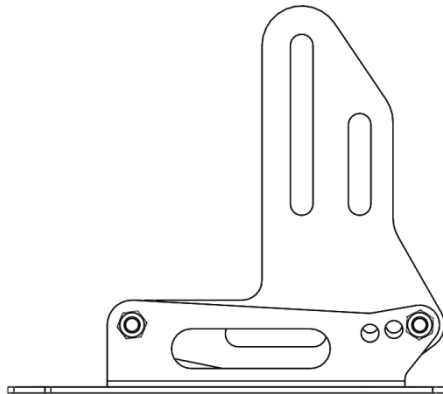
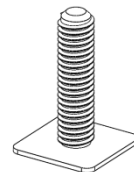

3



4

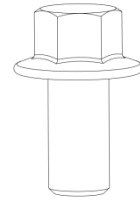

5

1. If you already have a splitter blade skip to step 8
2. Visit <https://honeddevelopments.com/product/splitter-mount-kit/> and download "honed_splitter_template_blank_841x1700.pdf"
3. Take this file to a local printer that can print on 841mm wide paper and have the template printed 1:1 scale.
4. Source 9mm plywood 1700mm long x 700mm wide minimum.
5. Cut out splitter blade template and then tape to plywood.
6. Trace splitter profile onto plywood with marker pen.
7. Cut plywood with Jigsaw or by other means.
8. Jack up car and support on jack stands
9. Remove the factory tie down points and install the chassis side splitter assemblies to the car. Etched marking to the inside.

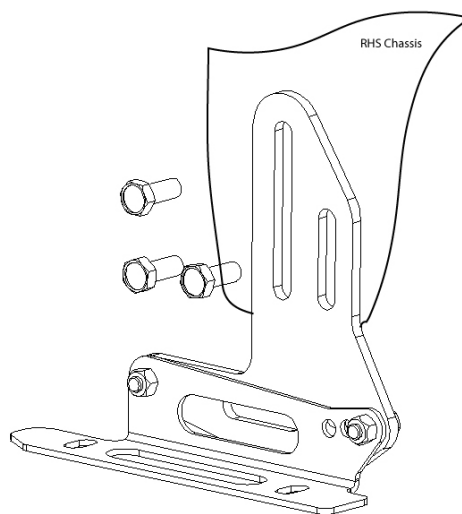
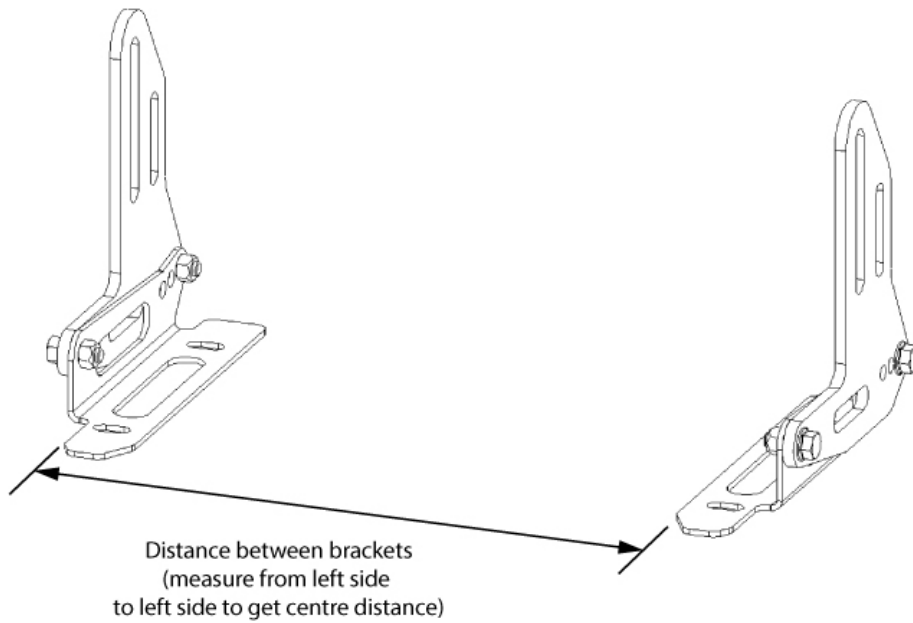
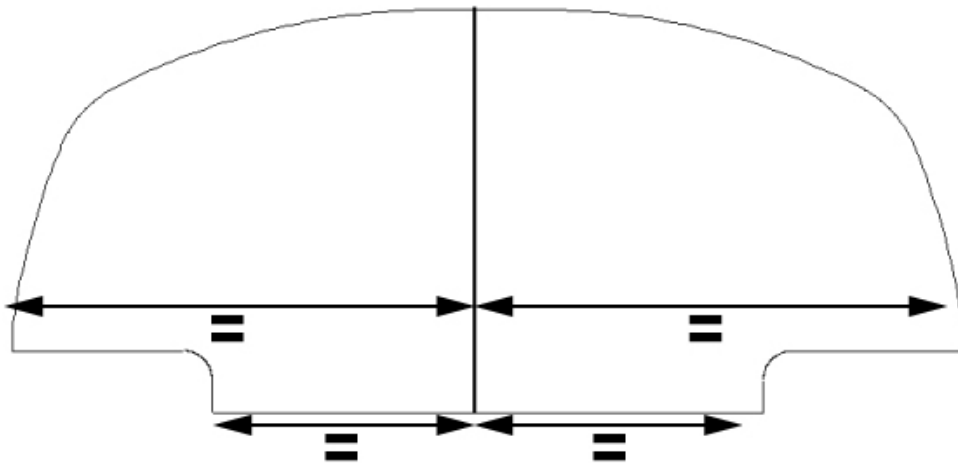

Figure 1: RHS (Drivers perspective) chassis side splitter assembly

10. Find the distance between brackets once both sides are installed on the car



11. Mark out centreline on splitter blade



12. Mark out bracket position lines, $X = \text{Distance between brackets}/2$

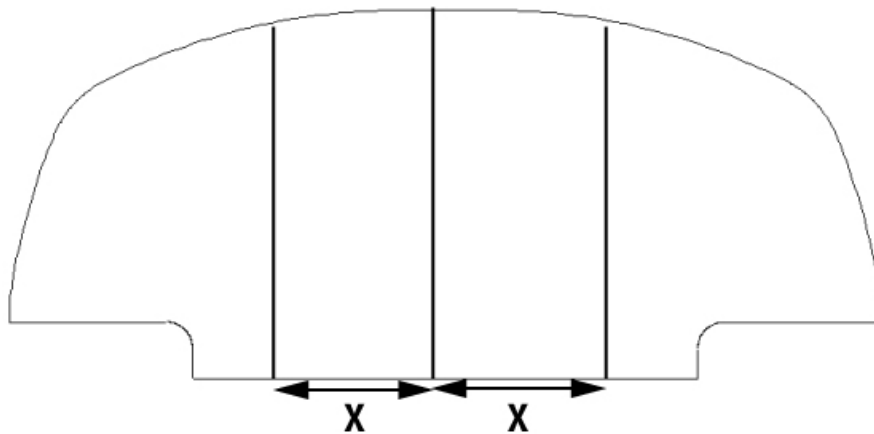

13. Offer splitter blade up to car, press it against bottom of splitter mounts attached to car. This step is easier with a second set of hands to support splitter blade.

14. Centre splitter blade best as possible on vehicle centreline.

15. Position the blade with ~50mm (2") protruding forward from leading edge of your bumper/lip.
16. Measure along one of the bracket position lines from the edge of the splitter back to the front edge of the bracket attached to the car.
17. With splitter blade back on bench, mark this position on each of the bracket position lines and then scribe a horizontal line across the splitter

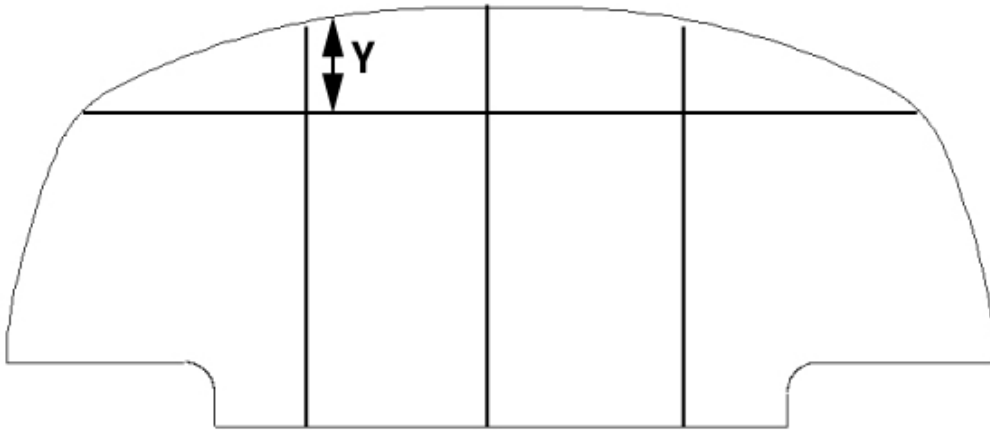

18. Cut "Honed Splitter Bracket Template" in half down the indicated centre line

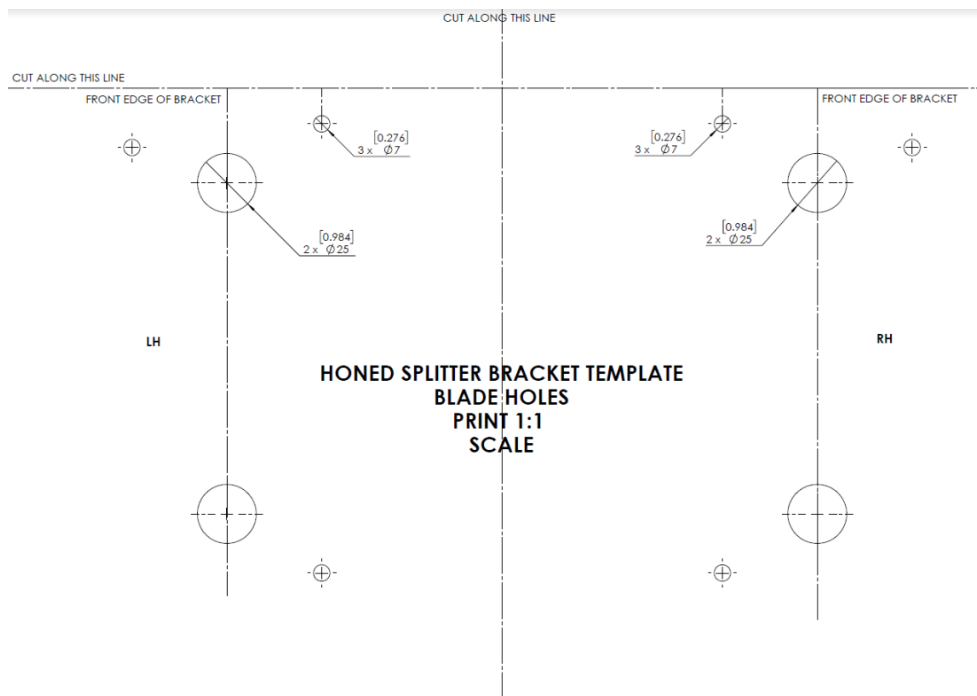

19. Line up the drilling templates with the lines on the splitter blade as shown below. Tape templates down.

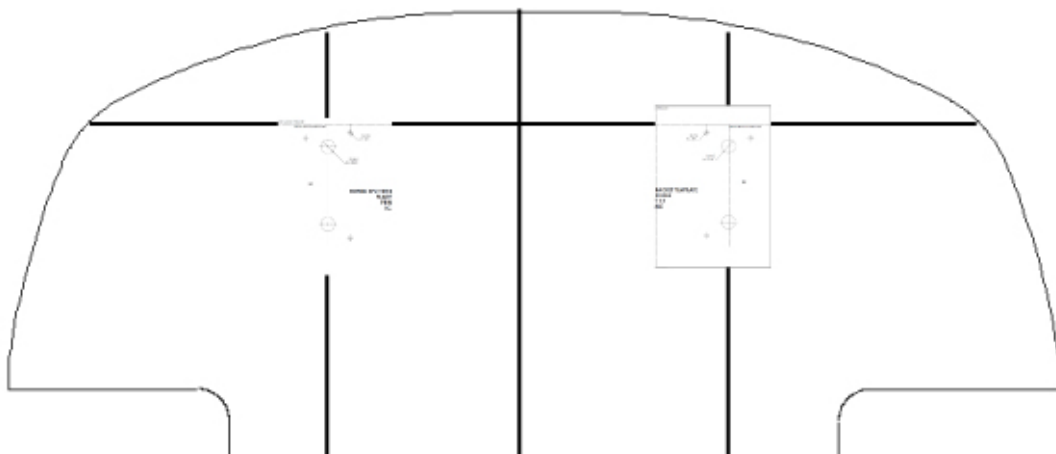

20. Centre punch or pilot drill through the template into your blade and then follow through with bits to create the specified holes sizes

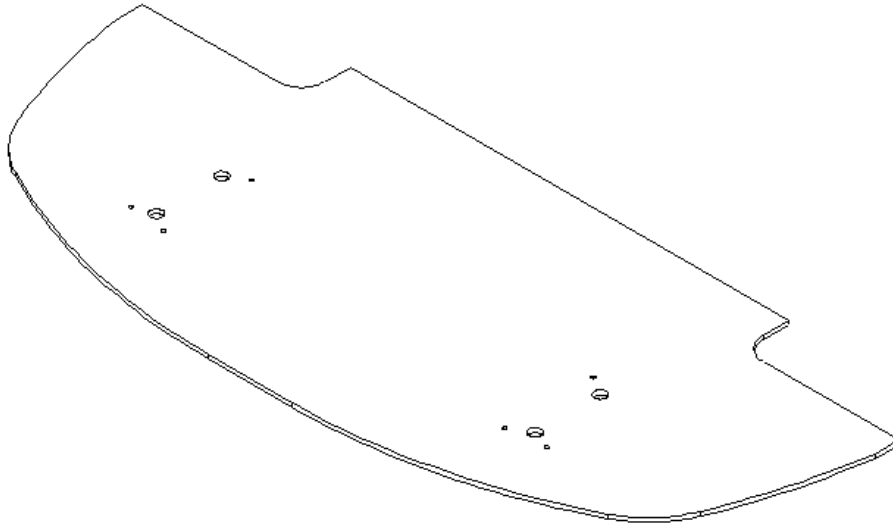

21. Bolt the splitter blade side brackets to the splitter and test fit

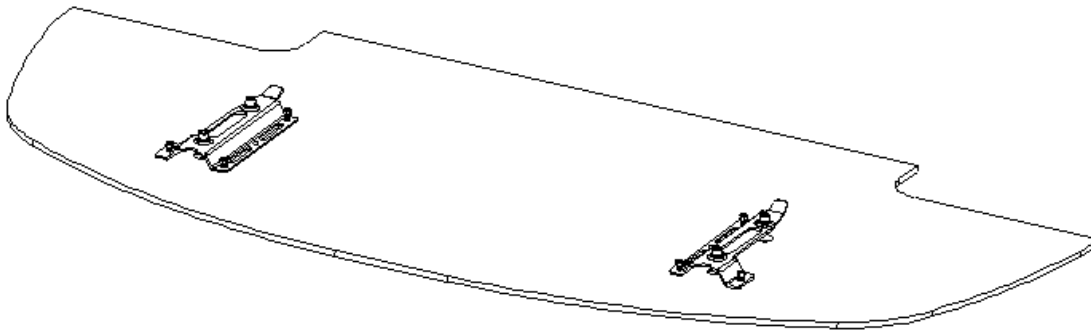

22. Use a marker pen to trace the profile of your bumper/lip down onto the splitter blade

23. We use a wheel arch flare screwed to the splitter to fill the gap between the splitter and the bumper/lip

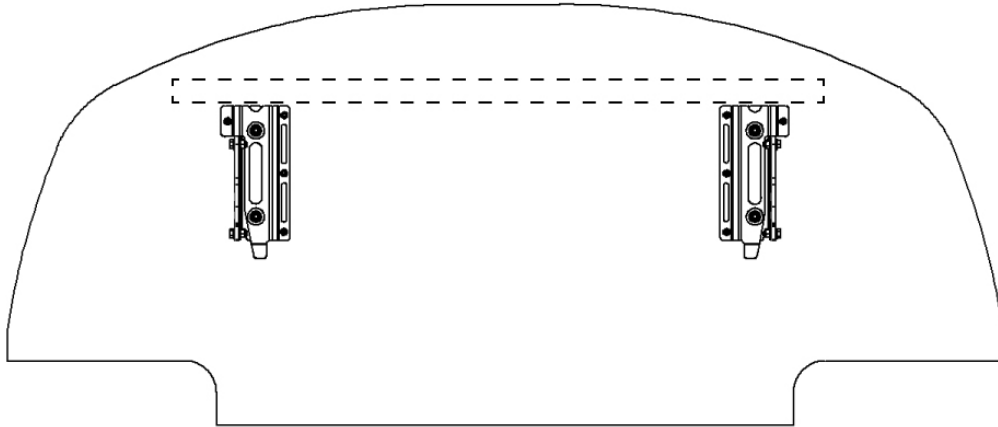

Figure 2: Normal orientation of wheel arch flare (as sold)

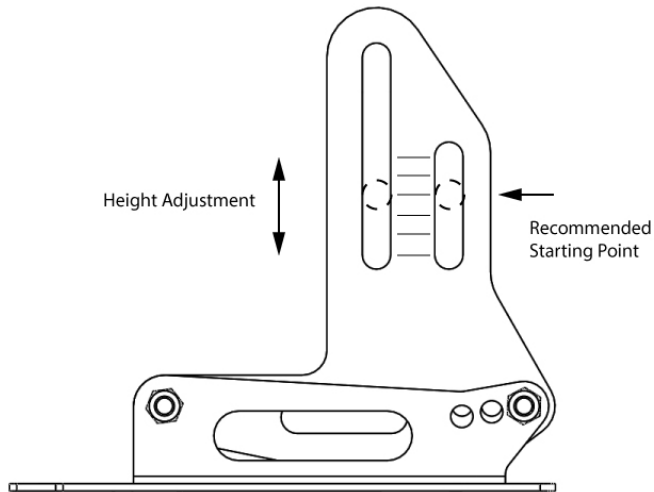

Figure 3: As used on splitter

24. We recommend adding additional bracing in the area shown below



25. Height Adjustment



26. Angle of attack adjustment

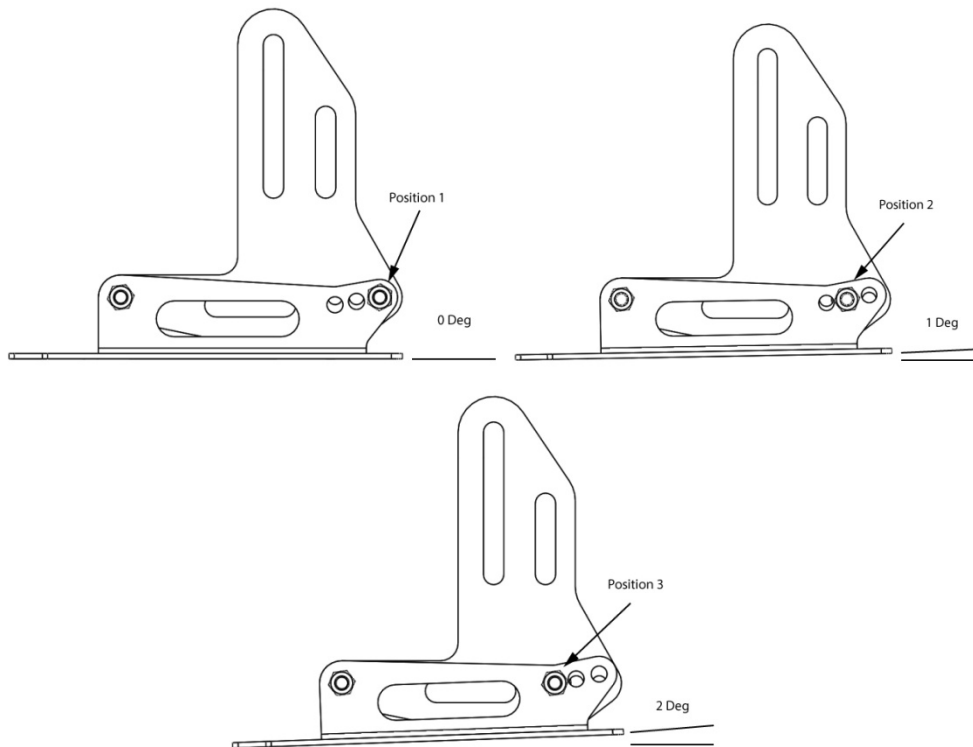

Note: These components are intended for race use only, and will require regular inspection and maintenance. Honed will not be held responsible for any misuse of the components.